

with Installation Instructions

Owner's Manual

Banks High-Flow Boost Tubes Stock Fitment

2011-2016 Chevy/GMC Turbo-Diesel Pickup Trucks

THIS MANUAL IS FOR USE WITH PART NUMBER 25993

Gale Banks Engineering
546 Duggan Avenue • Azusa, CA 91702
(626) 969-9600 • Fax (626) 334-1743

Product Information & Sales: (888) 635-4565
Customer Support: (888) 839-5600
Installation Support: (888) 839-2700

bankspower.com



Step-by-step installation video:
Bankspower.com/v/install-lml-boost-tubes

General Installation Practices

Dear Customer,

If you have any questions concerning the installation of your Banks Intercooler, please call our Technical Service Hotline at (888) 839-2700 between 7:00 am and 4:00 pm (PT). If you have any questions relating to shipping or billing, please contact our Customer Service Department at (888) 839-5600.

Thank you.

- 1.** Before starting work, familiarize yourself with the installation procedure by reading all of the instructions.
- 2.** Throughout this manual, the left side of the vehicle refers to the driver's side, and the right side to the passenger's side.
- 3.** Disconnect the negative (ground) cable from the battery (or batteries, if there are two) before beginning work.
- 4.** Route and tie wires and hoses a minimum of 6" away from exhaust heat, moving parts and sharp edges. Clearance of 8" or more is recommended where possible.
- 5.** When raising the vehicle, support it on properly weight-rated safety stands, ramps or a commercial hoist. Follow the manufacturer's safety precautions. Take care to balance the vehicle to prevent it from slipping or falling. When using ramps, be sure the front wheels are centered squarely on the topsides. When raising the front of the vehicle, put the transmission in park (automatic) or reverse (manual), set the parking brake, and block the rear wheels. When raising the back of

the vehicle, be sure the vehicle is on level ground and the front wheels are blocked securely.

Caution! Do not use floor jacks to support the vehicle while working under it. Do not raise the vehicle onto concrete blocks, masonry or any other item not intended specifically for this use.

6. During installation, keep the work area clean. Do not allow anything to be dropped into intake, exhaust, or lubrication system components while performing the installation, as foreign objects will cause immediate engine damage upon start-up.

TOOLS REQUIRED:

- 3/8 Drive ratchet
- Ratchet extension
- Inch and metric deep sockets
- Phillips and flat blade screwdrivers

HIGHLY RECOMMENDED TOOLS:

- Foot-pound torque wrench
- Inch-pound torque wrench

Table of Contents

General Installation Practices	2
1. General Assembly	4
2. Section 1	5
Remove Air Cleaner Box, Baffle, & Fender liners	
3. Section 2	7
Install Driver (Left) Side Banks High-Flow Boost Tube	
4. Section 3	8
Install Passenger (Right) side Banks High-Flow Boost Tube	
5. Section 4	9
Reinstall Air Cleaner Box, Baffle, & Fender liners	

General Assembly

Item	Description	Part#	Qty
1	Banks Boost Tube, Left (Driver)	42332	1
2	Banks Boost Tube, Right (Passenger)	42331	1
3	Hose, Turbo Outlet </td <td>94299</td> <td>1</td>	94299	1
4	Hump Hose, 3.5" to 3.12" QD (Quick Disconnect)	94311	1
5	Hump Hose, 3.0" to 3.5"	94511	1
6	Hose, 3.5" to Throttle Body Inlet	94325	1
7	T-Bolt Clamp, 2.5"	92852	1
8	T-Bolt Clamp, Murray 359	92895	2
9	T-Bolt Clamp, 3.5" Spring Loaded	92897	4
10	T-Bolt Clamp, Murray 387	92899	1

Figure 1

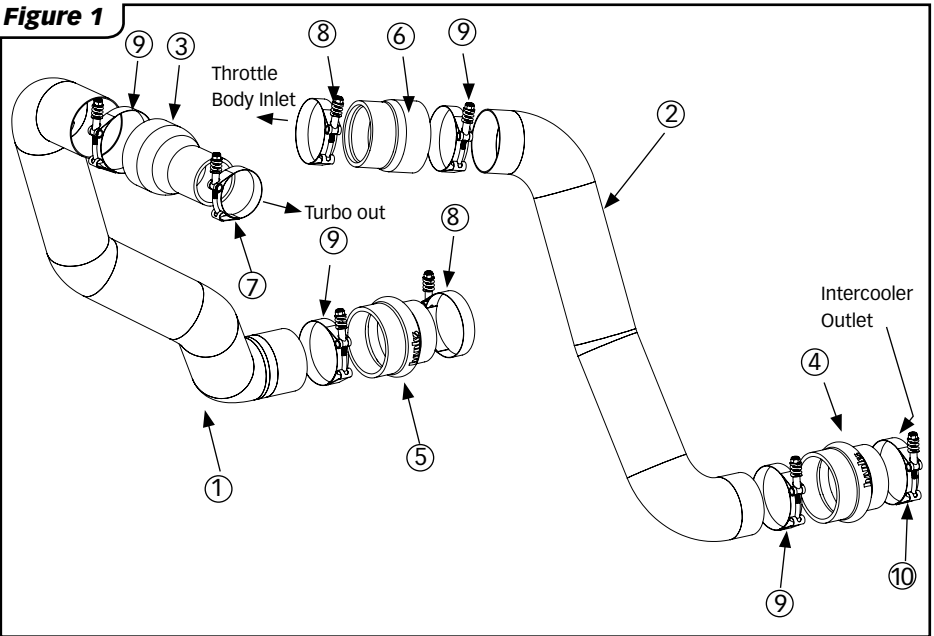

Section 1:

Remove Air Cleaner Box, Baffle, & Fender liners

1. Disconnect the ground cables from both the driver and passenger side batteries. Position the loose cables so that they do not come into contact with their respective battery posts during the installation.

2. Remove air cleaner box assembly. Loosen the hose clamp from the stock intake tube and separate the stock intake tube. Remove the Air Flow (MAF) sensor connector from stock air cleaner box filter cover. Remove stock air cleaner box by lifting the air cleaner box up and out. The bottom of the stock air cleaner box is held in place by rubber grommets. There may be some slight resistance when removing the stock air cleaner box.

NOTE: Be careful not to damage the connector or the MAF sensor.

NOTE: Number of sensors may vary with model year.

3. Remove the upper grill baffle.

Remove the upper grill baffle that mounts between the grill and radiator cross brace. The baffle is held in place by push-in retainers. The retainers are removed by pulling up on the center pin, then prying the retainer out of its hole as shown in **Figure 2**.

4. Remove the inner fender liners.

Remove the pushpin fasteners and bolts from both driver and passenger side fenderwell. Remove the fender liners.

Figure 2

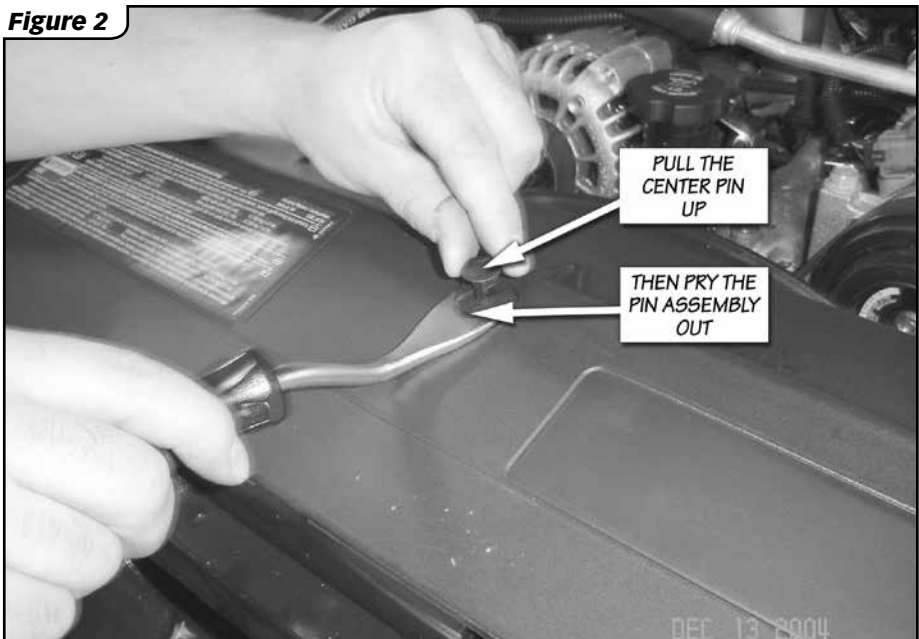

Section 1: Remove Air Cleaner Box, Baffle, & Fender liners, *(continued)*

5. Remove the air cleaner box support bracket. Remove the three bolt located in the passenger fender well as shown in **Figure 3**. Remove the two bolts located next to the coolant reservoir leg, and the two bolts on top of the bracket as shown in **Figure 4**. Pull the bracket down and out towards the rear of the vehicle to remove

NOTE: *The fasteners are accessed through the wheel arch opening. Pull the fender liner down approximately 6 inches once the fasteners are removed. Disconnect the wire harness retaining clips on top of the fender liner, and then remove the fender liner from the vehicle.*

Figure 3



Figure 4



Section 2: Install Driver Side (Left) Banks High-Flow Boost Tube

1. Loosen driver side stock boost tube hose clamps on the turbo outlet and intercooler inlet.

NOTE: The factory couplings and clamps will no longer be needed.

2. Pull the Stock boost tube out from the top of the engine.

3. Install silicone hose ⑤ onto the intercooler inlet side of the tube with both T-bolt Clamps ⑧ & ⑨ oriented as shown in **Figure 1** (Diagram) and **Figure 5**.

4. Slip the Banks High-Flow Boost Tube into place through the same opening that the factory tube was removed from step 2. Position the tube in place, slip the end into the silicone hose ⑤ on the intercooler inlet. See **Figure 1** (Diagram).

5. Install silicone hose ③ onto the turbo outlet with both T-Bolt Clamps ⑦ & ⑨ and connect with the corresponding end of the boost tube. See **Figure 1** and **Figure 6**.

6. Ensure the boost tube has adequate clearance from all surrounding components. Use a 7/16" or 11mm socket to torque the four T-Bolt clamps to 5ft-lbs (60 in-lbs).

Figure 5



Figure 6



7. Relocate ecu harness. The passenger side boost tube may pinch the orange ecu harness once installed (as seen in **Figure 8**).

8. Unhook the two clips on top, and one on the side, that hold the protective baffle above the ecu connections as shown in **Figure 8**.

9. On the innermost connector, slide the red locking tab up and swing the connection hinge up and out to release the connector. Reroute orange harness line above the high pressure line and black wire loom. Reconnect the ecu and protective baffle. See **Figure 9**

Figure 7



Section 2: Install Driver Side (Left) Banks High-Flow Boost Tube, *(continued)*

Figure 8



Figure 9

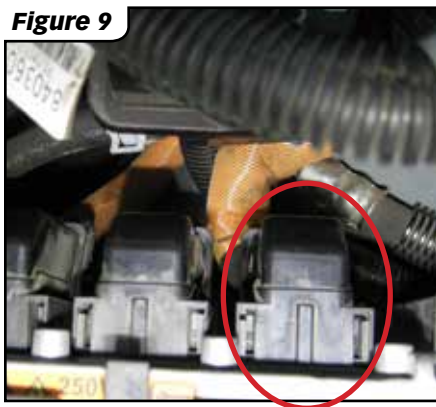

Section 3: Install Passenger (Right) Side Banks High-Flow Boost Tube

1. Remove intake air temperature sensor. See **Figure 10**.

Figure 10



2. Loosen passenger side stock boost tube retaining rings on the throttle body inlet and intercooler outlet.

4. Use a small screw driver to rotate the retaining ring to release the tube from the throttle body inlet, and then remove the stock boost tube. See **Figure 11**

Figure 11



5. Install silicone hose ⑥ onto the throttle body inlet with corresponding T-Bolt Clamps ⑧ & ⑨. See **Figure 1** and **Figure 12** (Diagram).

Figure 12



6. Install silicone hose ④ onto the intercooler outlet with the corresponding T-Bolt Clamps ⑨ & ⑩. See **Figure 1** and **Figure 13**.

Figure 13



7. Insert the passenger side Banks High-Flow Boost Tube, ensuring the correct ends go on their respective hose (See **Figure 1**).

8. Ensure the boost tube has adequate clearance from all surrounding components and use a 7/16" or 11mm socket to torque the four T-Bolt clamps to 5ft-lbs (60 in-lbs)

Section 4:

Reinstall Air Cleaner Box, Baffle, & Fender Liners

- 9.** Re-install air cleaner box support bracket and air cleaner box.
- 10.** Re-install the intake temperature air sensor.
- 11.** Secure IAT sensor harness as shown in **figure 14**.

Figure 14



- 12.** Install the upper grill baffle and secure with the push-in retainers that were previously removed. The push-in retainer with the center pin pulled out. Once the retainer is inserted, press the center pin down to secure the retainer.
- 13.** Install the driver side and passenger side fender liner. The charge air temperature before the intercooler approaches 400°F at full load. So, take care to route wiring away from the driver side boost tube and re-install the factory wire retainers on the fender liner.
- 14.** Re-install the connector on MAF sensor at the air cleaner box assembly
- 15.** Re- connect the ground cables on both batteries.

Gale Banks Engineering
546 Duggan Avenue • Azusa, ca 91702
(626) 969-9600 • Fax (626) 334-1743

Product Information & Sales: (888) 635-4565
Customer Support: (888) 839-5600
Installation Support: (888) 839-2700

bankpower.com