

**banks**

with Installation Instructions  
**Owner's Manual**

# **Banks Monster<sup>®</sup> Exhaust 5" System**

## **2010-2012 Ram 6.7L**

THIS MANUAL IS FOR USE WITH SYSTEMS: 49779, 49779-B,  
CCSB, MCSB, CCLB, INCLUDING DUALY MODELS

Gale Banks Engineering  
546 Duggan Avenue • Azusa, CA 91702  
(626) 969-9600 • Fax (626) 334-1743

Product Information & Sales: (888) 635-4565  
Customer Support: (888) 839-5600  
Installation Support: (888) 839-2700

**bankpower.com**

**BANKS**

# General Installation Practices

Dear Customer,

If you have any questions concerning the installation of your Banks Monster Exhaust System, please call our Technical Service Hotline at (888) 839-2700 between 7:00 am and 4:00 pm (PT). Watching our how-to video (link on the cover) may alleviate any further questions. If you have any questions relating to shipping or billing, please contact our Customer Service Department at (888) 839-5600.

Thank you.

1. Before starting work, familiarize yourself with the installation procedure by reading all of the instructions.
2. The exploded view (**Figure 2**) provides only general guidance. Refer to each step and section diagram in this manual for proper instruction.
3. Throughout this manual, the left side of the vehicle refers to the driver's side, and the right side to the passenger's side.
4. Disconnect the negative (ground) cable from the battery (or batteries, if there are two) before beginning work.
5. Route and tie wires and hoses a minimum of 6" away from exhaust heat, moving parts and sharp edges. Clearance of 8" or more is recommended where possible.
6. When raising the vehicle, support it on properly weight-rated safety stands, ramps or a commercial hoist. Follow the manufacturer's safety precautions.

Take care to balance the vehicle to prevent it from slipping or falling. When using ramps, be sure the front wheels are centered squarely on the topsides; put the transmission in park; set the hand brake; and place blocks behind the rear wheels.

**CAUTION! Do not use floor jacks to support the vehicle while working under it. Do not raise the vehicle onto concrete blocks, masonry or any other item not intended specifically for this use.**

**7.** During installation, keep the work area clean. Do not allow anything to be dropped into intake, exhaust, or lubrication system components while performing the installation, as foreign objects will cause immediate engine damage upon start-up.

## Tools Required:

- 1/2" and 3/8" drive ratchets with standard and metric sockets and 1/2" and 3/8" drive extension
- Standard and metric combination or open-end wrenches
- Standard screwdriver
- Clean shop towels or rags
- Pry-bar

## Highly recommended tools and supplies:

- Penetrating oil or light lubricant spray



## **! WARNING!**

**READ AND UNDERSTAND OWNER'S MANUAL PRIOR TO USE. FAILURE TO FOLLOW WARNINGS COULD RESULT IN SERIOUS INJURY OR DEATH.**

### **NORMAL OPERATION**

Do not park, idle, or drive your vehicle on dry grass or other dry ground cover. The emission system heats up the engine compartment and exhaust system, creating a risk of fire.

The normal operating temperature of the exhaust system is very high. Never work around or attempt to repair any part of the exhaust system until it has cooled. Use special care when working around the diesel oxidation catalytic converter or diesel particulate filter. The diesel oxidation catalytic converter and the diesel particulate filter heat up to very high temperatures after only a short period of engine operation and remain hot after you switch the engine off.

Stay clear of the exhaust tailpipe after prolonged driving. Hot exhaust gasses and coming in contact with the tailpipe and/or tailpipe tip can burn you badly.

### **REGENERATION**

Do not park or idle your vehicle over dry leaves, dry grass or other combustible materials. The regeneration process creates very high exhaust gas temperatures and the exhaust will radiate a considerable amount of heat during and after regeneration and after you have switched the engine off. This is a potential fire hazard.

The normal operating temperature of the exhaust system is very high. Never work around or attempt to repair any part of the exhaust system until it has cooled. Use special care when working around the diesel oxidation catalytic converter or diesel particulate filter. The diesel oxidation catalytic converter and the diesel particulate filter heat up to very high temperatures after only a short period of engine operation and remain hot after you switch the engine off.

Stay clear of the exhaust tailpipe during regeneration. Hot exhaust gasses and coming in contact with the tailpipe and/or the tailpipe can burn you badly.

**Figure 1** Banks Monster Exhaust, General Assembly

| Item # | Description       | Part #      | QTY |
|--------|-------------------|-------------|-----|
| 1      | Front Tailpipe    | 53341       | 1   |
| 2      | Rear Tailpipe     | 53340       | 1   |
| 3      | Tip, Tailpipe     | 52734/52735 | 1   |
| 4      | Intermediate Pipe | 53339       | 1   |
| 5      | Exhaust Clamp 5"  | 52473       | 3   |
| 6      | Exhaust Clamp 4"  | 52471       | 1   |

**Figure 2**

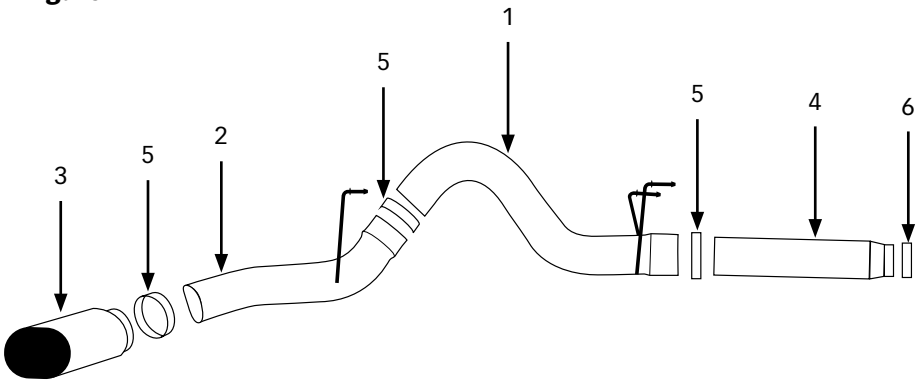

# OEM Exhaust Removal

**1.** As a precaution, disconnect the ground of the battery (if there is more than one battery, disconnect both).

**2.** Raise the vehicle and support it with properly weight rated safety stands, ramps or a commercial hoist. Follow the manufacturer's safety precautions. Take care to balance the vehicle to prevent it from slipping or falling. When using ramps, be sure the front wheels are centered squarely on the topsides; place the transmission in park; set the parking brake and place blocks behind the rear wheels.

**CAUTION: DO NOT WORK UNDER ANY VEHICLE SUPPORTED ONLY BY A JACK. SEVERE INJURY MAY RESULT.**

**WARNING! The following step may require the use of a torch and/or saw. Proper safety equipment should be used. Failure to use proper safety equipment may result in severe injury.**

**3.** Loosen all OEM exhaust clamps from the Diesel Particulate Filter outlet to the exhaust exit. **TAKE CAUTION TO NOT CUT OR DAMAGE DIESEL PARTICULATE FILTER TUBING DURING THE REMOVAL PROCESS.**

**4.** Remove the rear tailpipe rubber hanger with a pry bar. (Spray lubricant will ease removal.)

**5.** Remove the OEM exhaust from the DPF outlet and rearwards starting with the rear most section.

# Monster Exhaust System Installation

- 1.** Locate the supplied Banks intermediate pipe and cut based on the configurations in **Table 1**.
- 2.** Slide an exhaust clamp over the inlet of the Banks intermediate pipe. Install the intermediate pipe onto the Diesel Particulate Filter outlet. Loosely snug the clamp.
- 3.** Locate the supplied front tailpipe and install an exhaust clamp over the inlet of Banks front tailpipe. Install the front tailpipe onto the intermediate pipe. Reinstall the factory rubber hangers.
- 4.** Locate an exhaust clamp and the supplied Banks rear tailpipe. Install the clamp over the rear tailpipe inlet and install onto the Banks front tailpipe. Loosely snug the clamp.
- 5.** Insert the rear tailpipe hanger pin into the factory rubber hanger. Rotate the tailpipe until the hanger pins are parallel with the frame mounted pin. Loosely snug the clamp.

*Notes: Maintain an adequate air gap clearance of one (1) inch between the exhaust and the shock absorber and between the exhaust and the spare tire.*

**6. Figure 4** shows the positioning of the fubber hangers.

**7. Figure 5** illustrates the proper location of an exhaust clamp on a tubing joint.

**8.** Insert the tailpipe tip over the tailpipe outlet. Adjust the tip past the edge of the body or where aesthetically pleasing.

**9.** Remove the protective covering from the tailpipe tip.

**CAUTION: The protective covering may ignite and burn if not removed prior to running the engine.**

**10.** With everything positioned properly, begin to tighten the clamps starting with the ones closest to the DPF outlet and working your way back. Torque the exhaust clamps to 50 ft-lbs.

**Figure 3**

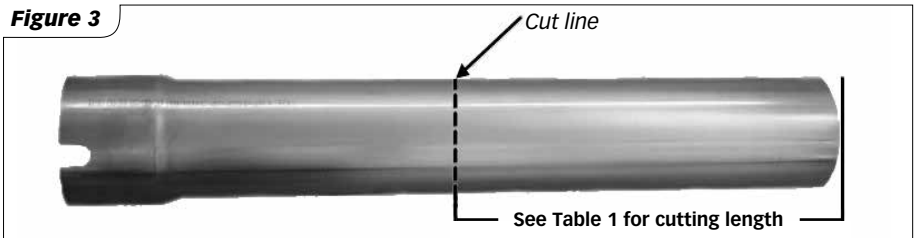
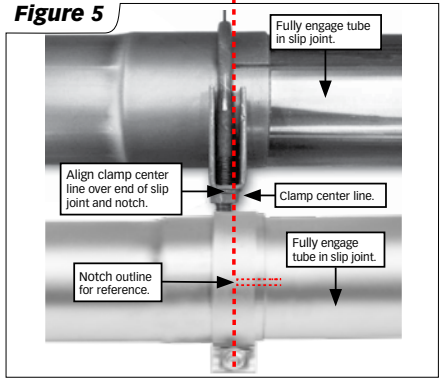
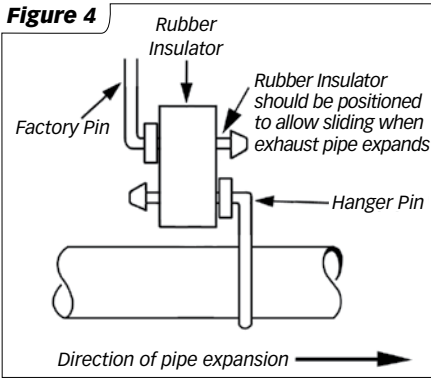

**Table 1**

| 2010-2012          |            |   |
|--------------------|------------|---|
|                    | Wheel Base | Cut this length from the Intermediate Pipe. See <b>Figure 3</b> . |
| Crew Cab/Short Bed | 149.5"     | 20"   |
| Mega Cab/Short Bed | 160.5"     | 9"  |
| Crew Cab/Long Bed  | 169.5"     | No Cut  |

**11.** Re-connect the negative battery cable. Start the engine and listen for exhaust leaks. Tighten the exhaust clamps as necessary. Whenever possible, tack weld slip connections to prevent disengagement is recommended. The Banks Monster Exhaust installation is now complete.

**12.** Your system includes two (2) Banks power logos. The logos can be mounted 1/2" to 1" below the "Cummins Turbo Diesel" emblem on the driver-side and passenger-side front fenders. (Figure 6)



Gale Banks Engineering  
546 Duggan Avenue • Azusa, CA 91702  
(626) 969-9600 • Fax (626) 334-1743

Product Information & Sales: (888) 635-4565  
Customer Support: (888) 839-5600  
Installation Support: (888) 839-2700

**bankspower.com**